

Rancho Terra Norte



1227 E. County Road 82
Wellington, CO

American Herding Breed Association
Large Flock Ranch (RLF) Trial
Saturday, July 6, 2019

Ranch (HRD) Trial
Sunday, July 7, 2019

**Arena (HTAD) & Field (HRD) Trial
and Tests (JHD & HCT)**
Wednesday, July 10, 2019

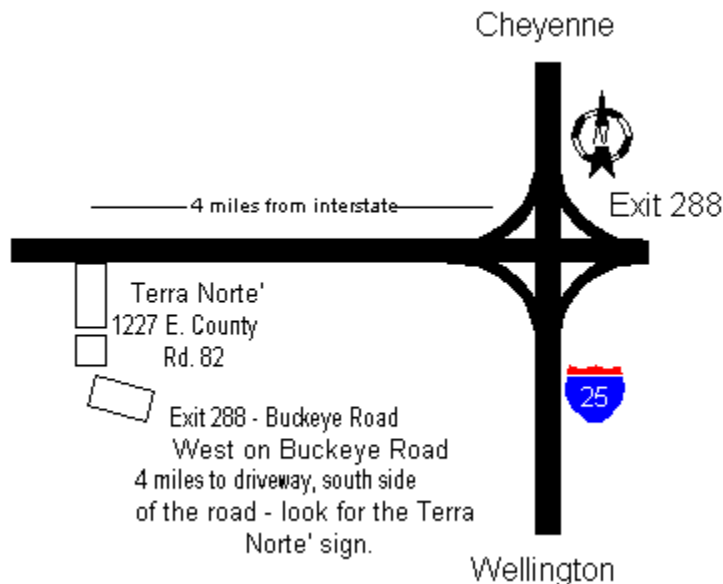

LFR I, II, III Sheep and goats
HRD I, II, III – mixed/sheep & goats, and sheep only
HTAD I, II, III – sheep, course 5: take pen, gate sort
HTAD I, II, III – goats, course 5: take pen, gate sort
HTAD I, II, III – ducks, course 5: take pen, gate sort
HTD I, II, III – sheep, ducks and goats

Junior Herding Dog – sheep or goats

Herding Capability Test – sheep or goats

PERMISSION HAS BEEN GRANTED BY THE AMERICAN HERDING BREEDS ASSOCIATION (AHBA) TO HOLD THE TRIALS UNDER AHBA RULES AND REGULATIONS.

A complete list of the rules governing AHBA events can be found at www.ahba-herding.org. Entrants are encouraged/requested to review and become familiar and knowledgeable with these regulations
(Dogs must be 9 months or older for trials)

Entry Fees – Herding Capability & Jr. Herding Dog tests: \$45

Herding Trial Arena Dog (HTAD) trial classes: \$45

Herding Ranch Dog (HRD) trial classes: \$50

Large Flock Ranch (LFR) trial classes: \$50

Day of event entries will be accepted ONLY if space and/or time allows.

RLF and HRD trials limited to 12 runs per day
Total entry limit 40 combined Test & Trial

Stock: Sheep/Value \$200

St. Croix, woolies & mixed hair &/or woolies in a rainbow of colors.

Goats/ Value \$175 Boer crosses and Kikos

Ducks/Value \$50

RLFsg (20+) sheep or goats per run

HTADsg (5) sheep or goats per run

HTDd and HTADd (5) ducks per run

HRDm (5 – 15) sheep and (10) goats per run

HCT & JHD (3) sheep or goats per run

RIBBONS WILL BE AWARDED FOR FIVE PLACES IN EACH CLASS/QUALIFYING RIBBONS TO EACH QUALIFIER

PRIZES:

Large Flock Ranch Trial - High in Trial: Ceramic plate with sheep motif
Large Flock Ranch Trial - Reserve High in Trial: Notecard set with sheep motif

Ranch Trial - High in Trial: Ceramic cup with sheep motif
Ranch Trial - Reserve High in Trial: Notecard set with sheep motif

HTD/HTAD Trial – High in Trial: Ceramic bowl with cattle motif
HTD/HTAD Trial – Reserve High in Trial: Notecard set with sheep motif

JUDGES:

RLF Sheep and goats will be judged by Mary Alice Wisecarver, Colo. Springs, CO
HRD Mixed & Sheep only will be judged by Mary Alice Wisecarver, C. Springs, CO
HTD & HTAD Sheep and goats will be judged by Linda Holloway, Ponca City, OK
HTD and HTAD Ducks will be judged by Mary Alice Wisecarver, C. Springs, CO

HCT & JHD Tests will be judged by
Sherry Kaltenborn (Leg 1), New River, AZ
Mary Alice Wisecarver (Leg 2), Colorado Springs, CO

Trial hours

Saturday, July 6, 2019 - 7:00 am to 7:00 pm

Sunday, July 7, 2019 - 7:00 am to 7:00 pm

Wednesday, July 10, 2019 - 4:00 PM to 10:00 pm

This event will be held outdoors regardless of weather

Trial Secretary:

Val Manning
1227 E County Road 82, Wellington CO 80549
970-568-7708, TerraNorte@aol.com

Course director: Val Manning -- Stock supervisor: Doug Richardson

VETERINARIAN (on call):

Richard Wheeler, DVM Poudre River Veterinary Clinic
970-227-2320

Motels That Will Accept Dogs

Days Inn, 7860 6th Street, Wellington, CO (970) 568-0444

Days Inn, 3624 E. Mulberry, Fort Collins, CO (970) 221-5490

Fort Collins LaQuinta, 3709 E. Mulberry, Fort Collins, CO (970) 493-7800

Sleep Inn, 3808 E. Mulberry, Fort Collins, CO (970) 484-5515

Guesthouse Inn, I-25, Ault exit 269A, 4333 East Mulberry, Fort Collins, CO (970) 493-9000

Plaza Inn, I-25, exit 269B, 3836 E. Mullberry, Ft. Collins, CO (970)484-4660

Camping Grounds -

Wellington KOA – 4821 E County Rd 70 (Owl Canyon Road), Wellington, CO (970) 568-7486

Fort Collins / Poudre Canyon KOA – 6670 US-287, La Porte CO (970)493-9758

Fort Collins/Lakeside KOA 1910 Lakeside Resort Lane, Fort Collins, CO (970)484-9880

Terry Bison Ranch Resort – 51 I-25 Service Road East, Cheyenne, WY 82007 (307) 634-4171

* Limited RV parking is available on site for self contained units. Please contact Val Manning (TerraNorte@aol.com) for more information.

The Northern Colorado Herding Cooperative will be providing concessions for purchase each day. The nearest outside food is 10 miles away from the trial site.

RTN—Large Flock Course Diagram

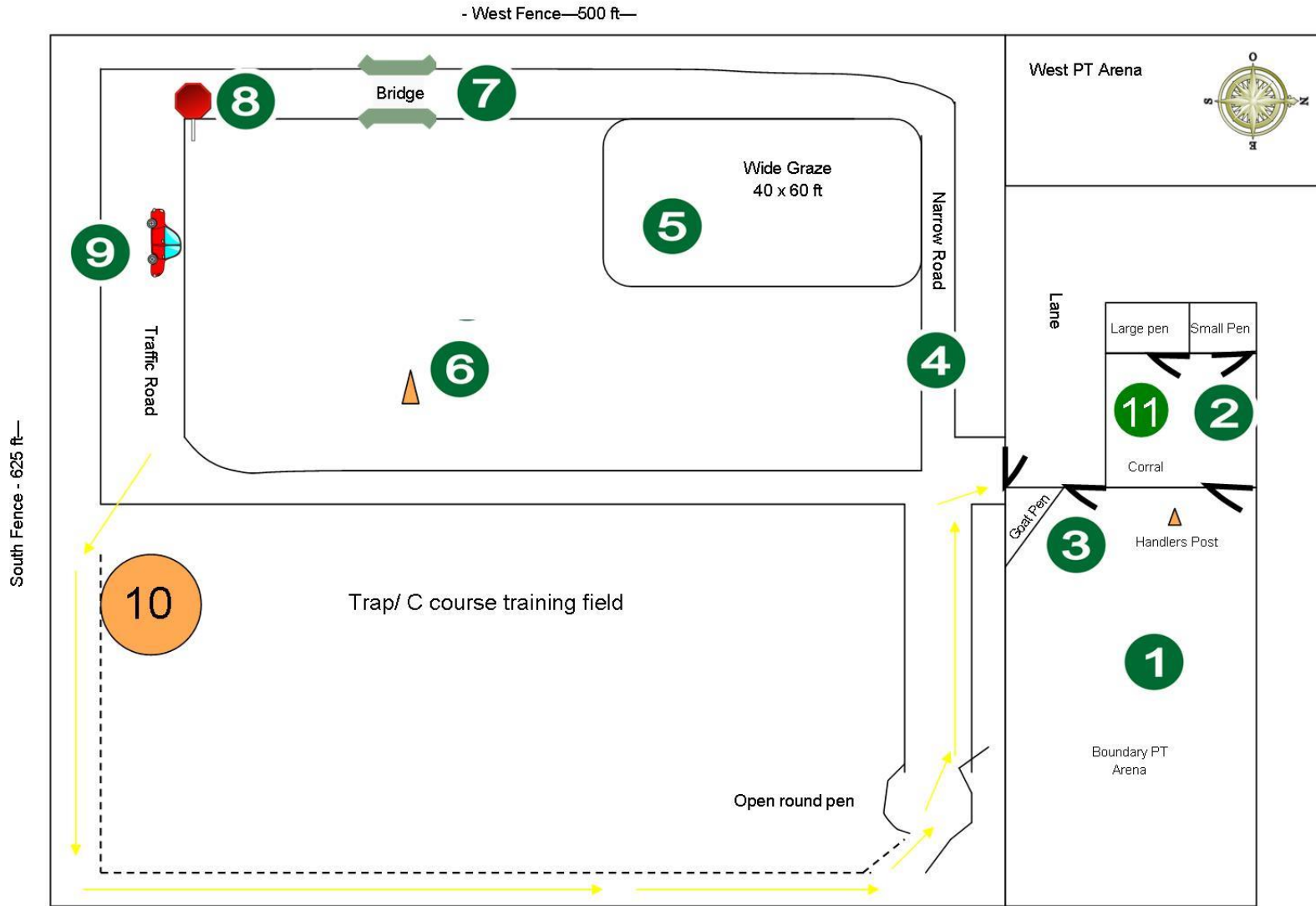

RTN – Ranch Trial, Large Flock
Sheep Course and Goat Course
July 6, 2019

Judge: Mary Alice Wisecarver

25+ head of sheep or 25+ head of goats are contained in the PT Boundary Arena – Handler and dog enters from the West gate.

1. (10 pts) Gather: Stock are gathered from the PT Boundary arena and brought to the corral
 - a. H1 – may position dog halfway from the handler’s post to the stock, handler may approach within 15 ft of stock.
 - b. H2 – dog is positioned at the handler’s post, handler may move half way between post and stock.
 - c. H3 – dog is positioned at the handler’s post and handler must remain at the post until the stock is standing at the corral gate.
2. (10 pts) Sort: The handler sorts 5 sheep into the large pen and another 5 head into the smaller pen.
 - a. H1 – may sort any 5 head into each pen
 - b. H2 – may sort any 5 head with collars into each pen
 - c. H3 – must sort 5 head with the same color collar into each pen (all red, all black, etc)
3. (10 pts) Gates: Difficult Passage
Handler and dog take remaining sheep or goats out of the corral, around to the west gate of the PT boundary arena, dog holds the stock while the handler opens the West PT boundary gate and controls them through the gate while the handler closes the gate after the flock passes through. The handler then moves to the silver gate of the Trap. The dog assists the handler to get the stock through this gate and holds the stock while the handler closes the gate.
4. (10 pts) Narrow road: The handler leads the stock along the narrow road towards the wide graze area located in the northwest corner of the trap. The stock is to stay on the road and move in a calm organized manner.
5. (10 pts) Wide Graze: Once the handler and stock reach the entrance on the west side of the graze, the stock is allowed to enter the graze and settle. The dog is expected to keep the stock within the graze area for the duration of the graze (5 minutes)
6. (10 pts) Gather 2:
 - a. H3 - The handler leaves the stock and the dog is taken to a handler’s post in the center of the trap. The handler sends the dog from the post to gather the stock and fetch them to the handlers post and then back to the road to continue the course

- b. H2 – The handler must position the dog at a point halfway from the graze and the H3 handlers post to gather the stock towards the handler and then back to the road to continue the course.
 - c. H1 – The handler sends the dog to gather the stock from the graze and returns to the road to continue the course.
7. (10 pts) Bridge: Handler and dog take the flock across the bridge.
 - a. H1 & H2: may position themselves as necessary to accomplish the task
 - b. H3 – The handler must go no further than the edges of the bridge and must remain there until the dog pushes the stock through the bridge, whereupon the handler may move.
8. (5 pts) Traffic Stop: The handler positions the dog to affect a stop and hold prior to the stock entering the traffic road allowing the handler to check for traffic. Once the handler determines the road is safe, the handler leads the flock onto the traffic road
9. (10 pts) Passage of the Car: With the dog working between the car and the flock, preventing the flock from interfering with the car or being endangered by the car. The flock should continue to move during the passage.

H1 & H2 handlers will turn off the traffic road onto the narrow road returning to the silver gate. The livestock is moved through the 2 gates (from the trap into the lane, then from the lane into the PT).

10. (10 pts) (* H3 only special task) H3 handlers will first stop the flock at the intersection of the traffic & narrow road, then proceed down the fence line to the SE corner of the field, turn north and moving along the fence proceed through the back of the free standing pen and out the gate to rejoin the road. The flock must stay within 12 ft of the fence when not on the road.
11. (5 pts) The handler and dog then return to the corral pens and un-pen the livestock in each pen and exhaust them into the PT with the balance of the flock. Time ends when the dog and handler exit the west gate of the PT boundary arena.

Tie breaker #1 – best score on #6

Tie breaker #2 – best score on #2

H1 & H2 maximum points 90 H3 maximum points 100

RTN AHBA HRD Mixed Ranch Course Diagram
Sunday, July 8, 2018

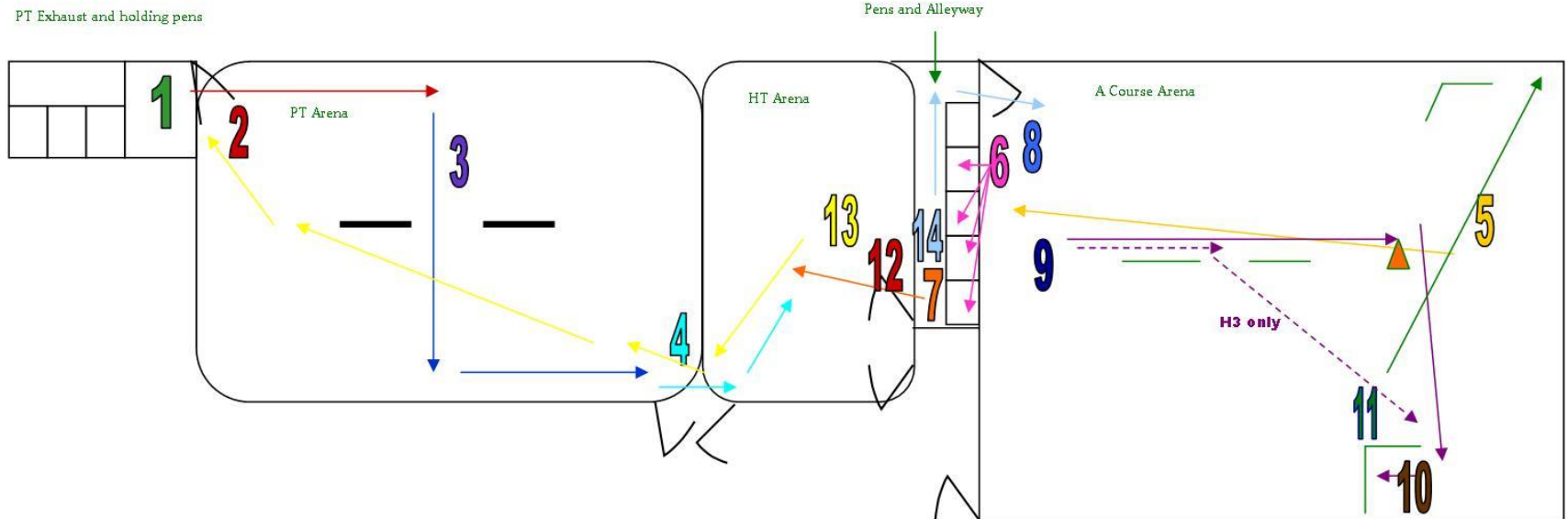

RTN AHBA HRD Mixed Course Description

Judge: Mary Alice Wisecarver

July 7, 2019

Course starts with 6 collared goats and 10 collared sheep on the A course and 4 goats without collars in the PT arena take/exhaust pen

1. Take Pen – remove the 4 goats in the PT arena from the pen
2. Fetch/Drive 1 - take them along the west fence to the middle of the arena.
3. Obstacle 1 - Fetch/drive across the arena through the cross-drive panels to the east fence and proceed to the north gate.
 - a. H1 is allowed to walk with stock, but may not enter obstacle.
 - b. H2 remains at the west fence until the stock have cleared the cross – drive panels, then may proceed.
 - c. H3 remains at the west fence until the stock has reached the east fence, then may proceed.
4. Controlled Access/Difficult Passage – move the 4 goats into the HT arena through the pass gate.
5. Gather - 6 goats and 10 sheep from the A course arena and take to the front of the holding pens.
6. Sort 1 – Sort 3 goats each into pens 1 & 2. Sort 5 sheep each into pens 3 & 4. Handler and dog move to the alleyway through pen #5.
 - a. H1 sorts any goats and any sheep
 - b. H2 sort goats by collar color, and any sheep
 - c. H3 sort goats and sheep by collar colors
7. UnPen the 2 sets of goats and move them into the HT arena with the other goats.
Handler and dog return to the A course through the alleyway and pen #5
8. Unpen the sheep from pen #4
9. Fetch/drive along the centerline of the arena, on the west side of the cross drive panels to the cone, then into the exam hold pen.

- a. H1: Handler may walk with the sheep around the cone and to the exam pen.
- b. H2: Handler may walk with sheep to the cone, but dog drives the sheep to the exam pen, handler is allowed to remain within 15 ft of the stock until they reach the pen (either parallel or following)
- c. H3: Take sheep through the cross drive panels and then over to the exam hold pen. Handler is not allowed to enter the cross-drive obstacle, but handler is allowed to remain within 15 ft of the stock until they reach the pen (either parallel or following).

10. H3 only (*) – handler enters the exam hold pen and catches a sheep designated by the judge.
11. Fetch/drive – sheep are removed from the hold pen and taken to the northwest corner of the arena (#2) and left.

Handler and dog returns to the HT arena

12. Sort 2 - Gate sort the goats with collars into the alleyway
13. Fetch/drive - Handler returns the 4 goats without collars to the exhaust pen in the PT arena.

Handler and dog return to the alleyway.

14. Unpen – release the goats in the alleyway and the sheep from pen #3 into the A course.

Time ends when the dog and handler enter the staging arena (either from the HT arena or the A course).

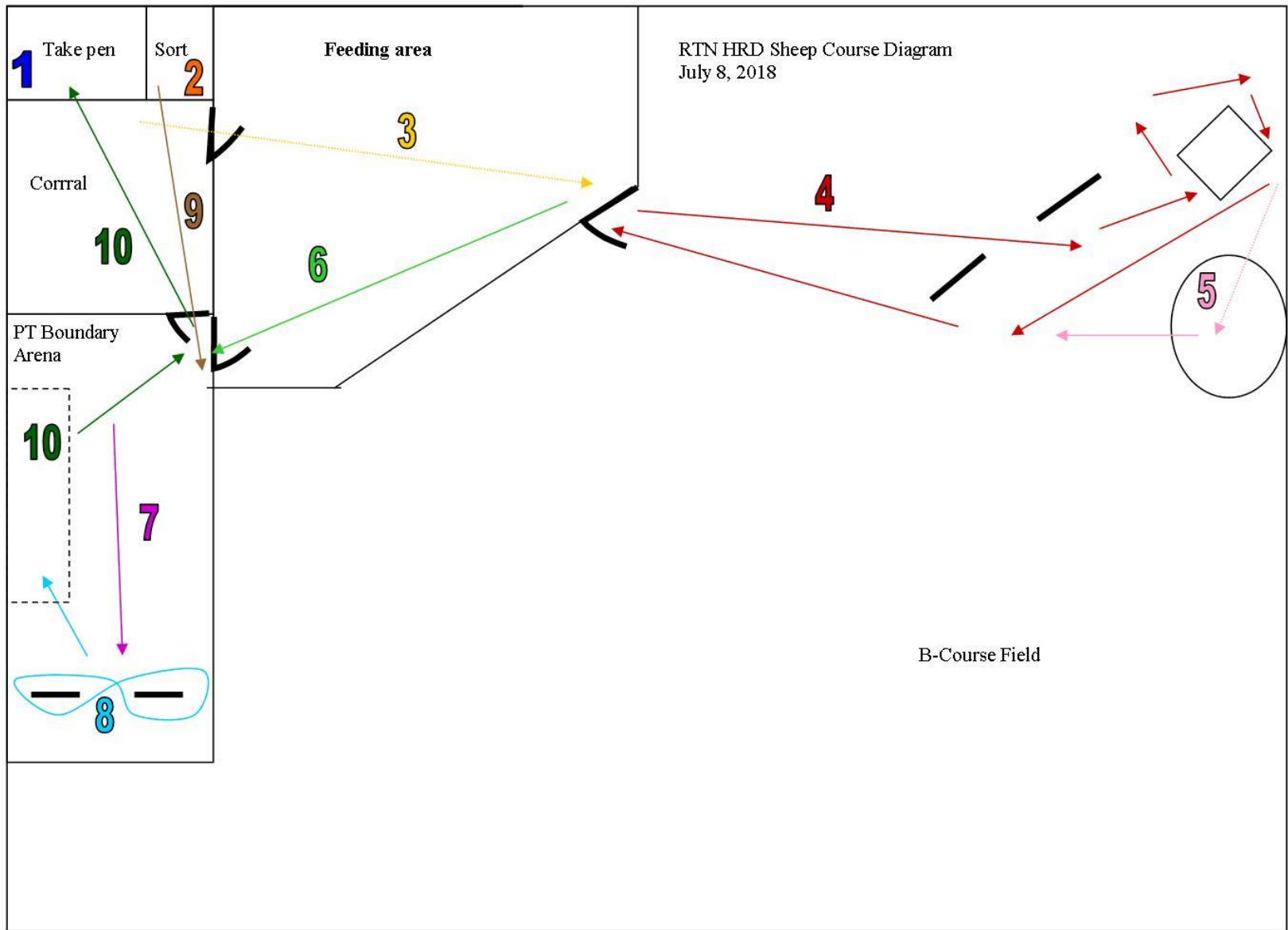

HRD Sheep Course Description
Judge: Mary Alice Wisecarver
July 7, 2019

1. Take Pen – Remove 15 head of sheep from large pen in barn.
2. Sort – Sort 5 head of sheep into the stall in barn.
 - a. Started/H1: Any 5 sheep
 - b. Intermediate/H2: Any 5 with at least 3 of the same color (ie: 3 red and 2 blue)
 - c. Advanced/H3: 5 sheep with the same colored collars (ei: all black or all blue)
3. Take 10 remaining head from the corral into the feed area and exit into the B course from the north gate.
4. Free standing obstacle – West drive panel/Free Standing Pen. Livestock are moved through the West drive panels, then around the free-standing pen.
 - a. Started/H1: may fetch/drive through west drive gate panels and then proceed around the free standing pen.
 - b. Intermediate/H2: may fetch/drive to a point on a line towards the free standing pen (staying at least 15 ft behind the dog) then fetch drive around the free standing pen.
 - c. Advanced/H3: handler must remain behind the west drive gate panel until the dog has driven the stock

around the back of the free standing pen. Handler may move once the stock has reached the pen.

5. H3 Only – Stock is taken to the shedding ring and handler must touch the head of a sheep designated by the judge.

The stock is then taken back through the feed area to the north gate of the PT Boundary arena and exhausted into the arena.

6. Outrun/Lift/Fetch – The sheep are gathered and taken to the advanced handlers post.
 - a. Started/H1: Dog is set at a cone 60 ft from the top of the arena, handler is allowed to move within 15 ft of stock.
 - b. Intermediate/H2: Intermediate post is halfway down the arena, and handler may move halfway to stock.
 - c. Advanced/H3: Advanced post will be set behind the PT panels
7. Figure 8 – The stock is moved in a figure 8 around the panels at the bottom of the arena, then moved to the graze area and left.
8. Handler and dog enter the corral and unpen the 5 head from the stall and exhaust them into the PT arena.
9. Handler and dog gather the 15 head and pen into the goat pen.

Time ends when the pen gate is closed.

Tie breakers – Best overall time, Best score on the outrun/lift fetch

RTN – HTADsgd Course 5 – Take pen, gate sort on sheep, goats and ducks

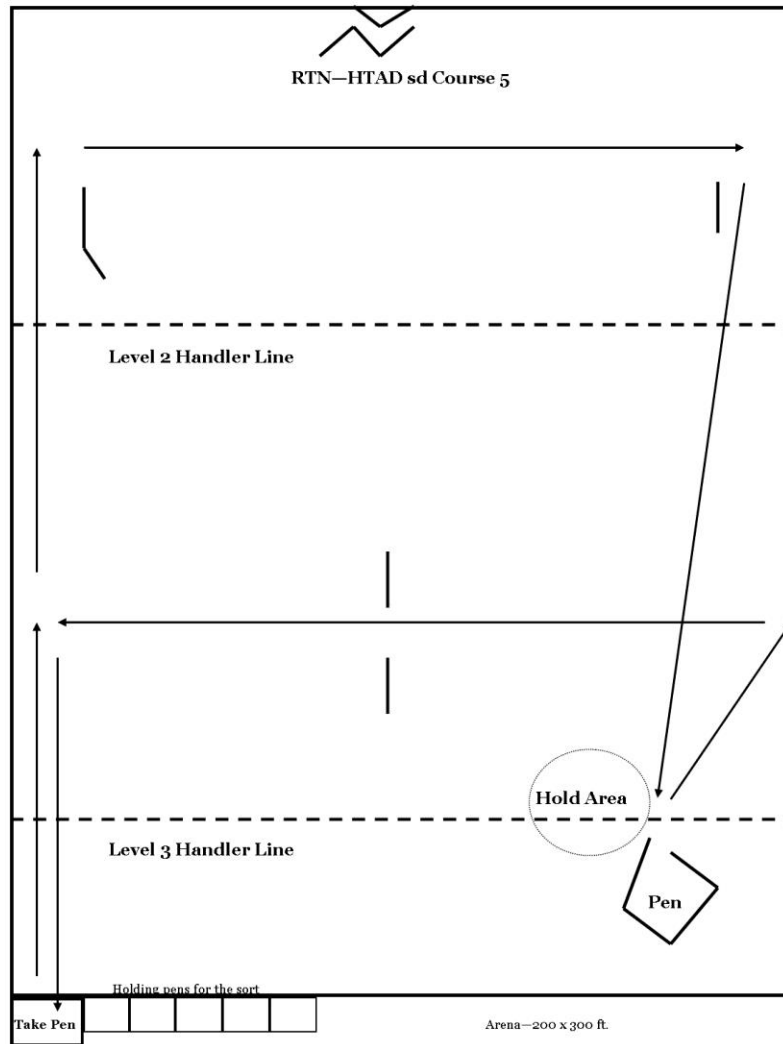

1. Take 5 head of stock from the take pen in the corner of the arena. **In all three classes, the lead is removed before the handler opens the take-pen gate.**
 - a. For exiting the stock, HTAD III handlers may not enter the pen.
 - b. For HTAD II, handlers may enter the pen with the dog but should not move the stock themselves.
 - c. For HTAD I, the handler may assist the dog in moving the stock. A heavy penalty shall be assessed for the handler going in the take pen alone (i.e., without using the dog) or for taking the dog in on lead. **If the stock come out on their own volition without the handler or dog entering, there is no penalty**
2. Proceed up the long end of the arena through the Y chute
 - a. H1 may fetch or drive up to the Y
 - b. H2 may fetch to the H2 handler line
 - c. H3 must remain behind H3 handler line
3. Turn right from the Y and fetch/drive stock across the arena to the breeze way panel, move sheep through breeze way.
4. Proceed to the free standing pen in the SE corner of the arena, pen the stock
5. Remove from the pen – hold in an area in front of the pen.
6. Proceed to #4 on the east fence, turn left and take stock through the cross drive panels from east to west.
7. (*) H3 Sheep and ducks – Gate sort sheep two sheep or ducks into holding pen.
8. Repen stock.
 - First tie breaker on #3
 - Second tie breaker on #4

AGREEMENT

In consideration for participation in an event sanctioned by the American Herding Breed Association (AHBA) and held at Rancho Terra Norte home of Val Manning and Doug Richardson, I (we) agree to assume all responsibility for any claim, loss or damage, of whatever kind or nature, whether to person or property, which may be caused at or near this event, either directly or indirectly, by me (us) or the dog(s) I (we) have entered in or brought to this event. I (we) further agree that I (we) will hold the AHBA, its officers, directors, agents and members and Val Manning and Doug Richardson, and their employees/help working this event, harmless and defend them from any and all liability for any injury, claim, damage or loss, of whatever kind or nature, whether to person or property, caused at or near this event. I (we) agree to indemnify the AHBA, its officers, directors, agents or members and Val Manning and Doug Richardson, and associated persons, for any loss, cost or expenses, including attorney fees and costs, to which the AHBA, its officers, directors, agents or members and Val Manning and Doug Richardson, and associated persons might be subject as a result of any claim, suit, loss or damage caused in any way by any act or negligence on my (our) part or on the part of any dog(s) I (we) have entered in or brought to this event. I (we) acknowledge that while the AHBA may provide sanctioning for this event with regard to the issuing of titles, it and Val Manning and Doug Richardson, and associated persons do not have and do not exercise control over the conduct of those present. I (we) certify and represent that the dog(s) I (we) have entered in or brought to this event is/are not a hazard to other dogs, other animals, or to people.

I (we) will pay for any livestock injuries or replacement value in the event of death of any livestock by my (our) dog(s). In case of any injury to any stock caused by the dog(s) entered or said dog(s) actions thereof, I (we) will assume total responsibility for any damage. I (we) agree to pay the full market value, as set forth and noted in this event's premium, of the injured animal in case of serious injury, or the veterinarian bill or its equivalent if the injury is slight.

Signature of entrant: X



Enter On-line!

It is now possible to enter RTN Herding Trials
On-line from our secure website!
www.ranchoterranorte.com
Click on the online store tab!
Entries will be accepted until 8 PM MST the day prior to the trial



Home of the Northern Colo Herding Co-op







I certify that I am the actual owner of the dog or that I am the duly authorized agent of the actual owner whose name I have entered above. In consideration of the acceptance of this entry, I (we) agree to abide by the rules and regulations of the American Herding Breed Association in effect at the time of this event and by any additional rules and regulations appearing in the premium list for this event and further agree to be bound by the "Agreement" printed on the reverse side of this entry form. I (we) certify and represent that the dog entered is not a hazard to person(s) or other dogs. This entry is submitted for acceptance on the foregoing representation and agreement:
 SIGNATURE of owner or agent duly authorized to make this entry:

X

TELEPHONE # _____

E-Mail: _____

AMERICAN HERDING BREED ASSOCIATION ENTRY FORM
Rancho Terra Norte' 1227 E. County Road 82 Wellington, CO 80549
AHBA Large Flock Ranch Trial – July 6, 2019, HRD Ranch Trial – July 7, 2019 and
AHBA HTAD and HTD Herding Trial/HCT & JHD Tests – July 10, 2019
 Judges: Mary Alice Wisecarver (LFRsg, HRDsm) Linda Holloway (HTADsg and HTDsg),
 Mary Alice Wisecarver (HTADD and HTDd, Tests Leg 2), Sherry Kaltenborn (Tests Leg 1)
 Entry Fees – RLF \$50, HRD \$50, HTD \$45, HCT & JHD \$45
 Closing when limits reached.

Entry limit: 18 tests, 12 RLF sheep and goats combined, 12 HRD mixed, and sheep only combined, 10 HTAD sheep, 10 HTAD goats, 10 HTAD ducks, 10 HTD Sheep, 10 HTD Goats, 10 HTD ducks
Day of entries accepted ONLY as space and/or time allows. Mail entries with fees to **Val Manning** 1227 E County Road 82, Wellington CO 80549. *Overnight delivery address: same.* You must WAIVE SIGNATURE on express entries. All entry fees payable in U.S. Funds. Use a separate entry form for each dog entered or if entry is different between each trial but entering all trials.

I enclose \$_____ for entry fees. **Make check or money order payable to Terra Norte'.**
IMPORTANT -- Read and Sign Reverse Side before completing. Must sign BOTH signature places.

Breed: _____ Sex: _____ Date of Birth _____

"Exhibition only" classes are offered at these trials.

Trial Class	Leg	Leg	Leg	Leg	Leg
RLFs I	<input type="checkbox"/> (1) <input type="checkbox"/> (2)	RLFg I	<input type="checkbox"/> (1) <input type="checkbox"/> (2)	HRDm I	<input type="checkbox"/> (1) <input type="checkbox"/> (2)
RLFs II	<input type="checkbox"/> (1) <input type="checkbox"/> (2)	RLFg II	<input type="checkbox"/> (1) <input type="checkbox"/> (2)	HRDs II	<input type="checkbox"/> (1) <input type="checkbox"/> (2)
RLFs III	<input type="checkbox"/> (1) <input type="checkbox"/> (2)	RLFg III	<input type="checkbox"/> (1) <input type="checkbox"/> (2)	HRDs III	<input type="checkbox"/> (1) <input type="checkbox"/> (2)
Trial Class	Leg	Leg	Leg	Leg	Leg
HTADg I	<input type="checkbox"/> (1) <input type="checkbox"/> (2)	HTADd I	<input type="checkbox"/> (1) <input type="checkbox"/> (2)	HTDs I	<input type="checkbox"/> (1) <input type="checkbox"/> (2)
HTADg II	<input type="checkbox"/> (1) <input type="checkbox"/> (2)	HTADd II	<input type="checkbox"/> (1) <input type="checkbox"/> (2)	HTDg II	<input type="checkbox"/> (1) <input type="checkbox"/> (2)
HTADg III	<input type="checkbox"/> (1) <input type="checkbox"/> (2)	HTADd III	<input type="checkbox"/> (1) <input type="checkbox"/> (2)	HTDg III	<input type="checkbox"/> (1) <input type="checkbox"/> (2)
Test Class	Leg	Leg	Non- Compete:	CH Pts:	
HCTg	<input type="checkbox"/> (1) <input type="checkbox"/> (2)	JHDg	<input type="checkbox"/> (1) <input type="checkbox"/> (2)	<input type="checkbox"/>	<input type="checkbox"/>

Full Name of Dog: _____

Registry & Number: _____ Call Name: _____

Breeder: _____

Sire: _____

Dam: _____

Actual Owner(s): _____

Owner's Address: _____

City _____ State _____ Zip _____

Name of Handler: If not owner. _____

AGREEMENT

In consideration for participation in an event sanctioned by the American Herding Breed Association (AHBA) and held at Rancho Terra Norte home of Val Manning and Doug Richardson, I (we) agree to assume all responsibility for any claim, loss or damage, of whatever kind or nature, whether to person or property, which may be caused at or near this event, either directly or indirectly, by me (us) or the dog(s) I (we) have entered in or brought to this event. I (we) further agree that I (we) will hold the AHBA, its officers, directors, agents or members and Val Manning and Doug Richardson, and their employees/help working this event, harmless and defend them from any and all liability for any injury, claim, damage or loss, of whatever kind or nature, whether to person or property, caused at or near this event. I (we) agree to indemnify the AHBA, its officers, directors, agents or members and Val Manning and Doug Richardson, and associated persons, for any loss, cost or expenses, including attorney fees and costs, to which the AHBA, its officers, directors, agents or members and Val Manning and Doug Richardson, and associated persons might be subject as a result of any claim, suit, loss or damage caused in any way by any act or negligence on my (our) part or on the part of any dog(s) I (we) have entered in or brought to this event. I (we) acknowledge that while the AHBA may provide sanctioning for this event with regard to the issuing of titles, it and Val Manning and Doug Richardson, and associated persons do not have and do not exercise control over the conduct of those present. I (we) certify and represent that the dog(s) I (we) have entered in or brought to this event is/are not a hazard to other dogs, other animals, or to people.

I (we) will pay for any livestock injuries or replacement value in the event of death of any livestock by my (our) dog(s). In case of any injury to any stock caused by the dog(s) entered or said dog(s) actions thereof, I (we) will assume total responsibility for any damage. I (we) agree to pay the full market value, as set forth and noted in this event's premium, of the injured animal in case of serious injury, or the veterinarian bill or its equivalent if the injury is slight.

Signature of entrant: X



Enter On-line!

It is now possible to enter RTN Herding Trials
On-line from our secure website!
www.ranchoterranorte.com
Click on the online store tab!

Entries will be accepted until 8 PM MST the day prior to the trial



Rancho Terra Norte
 Home of the Northern Colo Herding Co-op







I certify that I am the actual owner of the dog or that I am the duly authorized agent of the actual owner whose name I have entered above. In consideration of the acceptance of this entry, I (we) agree to abide by the rules and regulations of the American Herding Breed Association in effect at the time of this event and by any additional rules and regulations appearing in the premium list for this event and further agree to be bound by the "Agreement" printed on the reverse side of this entry form. I (we) certify and represent that the dog entered is not a hazard to person(s) or other dogs. This entry is submitted for acceptance on the foregoing representation and agreement:
 SIGNATURE of owner or agent duly authorized to make this entry:

X

TELEPHONE # _____

E-Mail: _____

AMERICAN HERDING BREED ASSOCIATION ENTRY FORM
Rancho Terra Norte' 1227 E. County Road 82 Wellington, CO 80549
AHBA Large Flock Ranch Trial – July 6, 2019, HRD Ranch Trial – July 7, 2019 and
AHBA HTAD and HTD Herding Trial/HCT & JHD Tests – July 10, 2019
 Judges: Mary Alice Wisecarver (LFRsg, HRDsm) Linda Holloway (HTADsg and HTDsg),
 Mary Alice Wisecarver (HTADD and HTDd, Tests Leg 2), Sherry Kaltenborn (Tests Leg 1)
 Entry Fees – RLF \$50, HRD \$50, HTD \$45, HCT & JHD \$45
 Closing when limits reached.

Entry limit: 18 tests, 12 RLF sheep and goats combined, 12 HRD mixed, and sheep only combined, 10 HTAD sheep, 10 HTAD goats, 10 HTAD ducks, 10 HTD Sheep, 10 HTD Goats, 10 HTD ducks
Day of entries accepted ONLY as space and/or time allows. Mail entries with fees to **Val Manning** 1227 E County Road 82, Wellington CO 80549. *Overnight delivery address: same.* You must WAIVE SIGNATURE on express entries. All entry fees payable in U.S. Funds. Use a separate entry form for each dog entered or if entry is different between each trial but entering all trials.

I enclose \$_____ for entry fees. **Make check or money order payable to Terra Norte'.**
IMPORTANT -- Read and Sign Reverse Side before completing. Must sign BOTH signature places.

Breed: _____ Sex: _____ Date of Birth _____

"Exhibition only" classes are offered at these trials.

Trial Class	Leg	Leg	Leg	Leg	Leg
RLFs I	(1) (2)	RLFg I	(1) (2)	HRDm I	(1) (2)
RLFs II		RLFg II		HRDm II	
RLFs III		RLFg III		HRDm III	
Trial Class	Leg	Leg	Leg	Leg	Leg
HTADg I	(1) (2)	HTADd I	(1) (2)	HTDs I	(1) (2)
HTADg II		HTADd II		HTDs II	
HTADg III		HTADd III		HTDs III	
Test Class	Leg	Leg	Non- Compete:	CH Pts:	
HCTg	(1) (2)	JHDg	(1) (2)		

Full Name of Dog: _____

Registry & Number: _____ Call Name: _____

Breeder: _____

Sire: _____

Dam: _____

Actual Owner(s): _____

Owner's Address: _____

City _____ State _____ Zip _____

Name of Handler: If not owner. _____